

ENR-1000

4-Channel Mini Standalone NVR



- Manage up to 4 IP cameras
- Support H.264 formats, local display up to 2-Megapixel resolution, remote display up to 5-Megapixel resolution
- Live view with 1, 4 window layouts
- PTZ and speed control, preset points and tours, mouse PTZ
- HDD Bay for 2 SATA disks (total up to 6 TB)
- Maximum total recording frame rate 120 fps
- Scheduled, event triggered and manual recording
- Time and event based search
- Playback with 1/2x-1x-32x speeds with AVI video export function
- 4-channel synchronized playback
- Event management with motion detection and DI/DO
- Built-in DHCP server support
- HDMI Local display
- Compact Design

PHOTO INDICATION

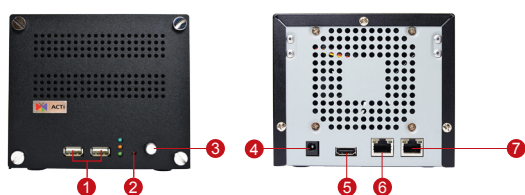

- | | |
|----------------------|-------------|
| ① USB 2.0 Ports | ⑤ HDMI Port |
| ② Reset Button | ⑥ LAN1 |
| ③ Power Button | ⑦ LAN2 |
| ④ DC 12V power input | |

DIMENSION DIAGRAM

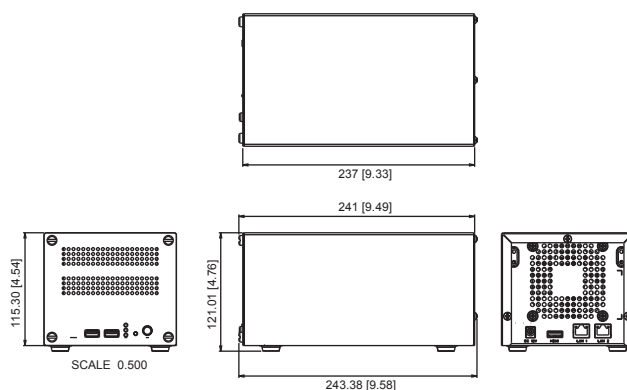

Unit: mm [inch]

SOLUTION ARCHITECTURE

Standalone NVR

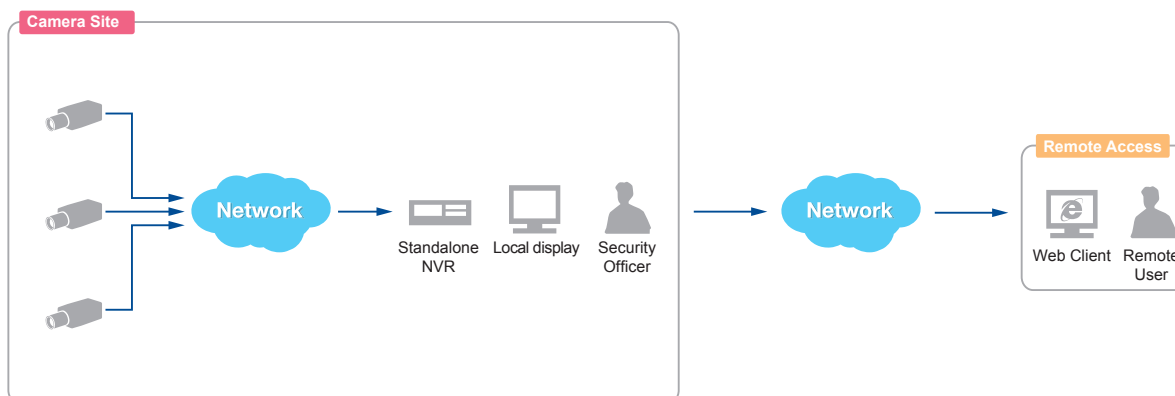

Remote User: Administrator / Supervisor / Manager / Security Officer

ENR-1000**PRODUCT SPECIFICATION****ENR-1000****• General**

Full Name	ACTi Standalone Network Video Recorder ENR-1000
Maximum Number of Clients	2
Maximum Number of Cameras	4
Compression	H.264
Maximum display resolution	1920X1080

• Live View

Display Layout Mode	1, 4
Layout Tour (Auto Patrol)	Automatic switch between different display layouts
Digital Panel	Zoom in digitally by mouse
Event status	Display status for network/record/motion upon every video region

• PTZ

Control	Pan, tilt and zoom controls; speed control
Preset Points and Tours	Go/set preset points
Number of Preset Points	32
Default Protocol	URL command

• Recording

Scheduled Recording	Record video with user defined schedule
Event Recording	Record video when the alarm event is triggered, including the pre-event buffered video clip
Event Speed-up Recording	Record I frame only in normal status, and record full frames when the alarm event is triggered
Manual Recording	Instant recording upon mouse click
Recording Frame Rate	Max 120 fps total; Max 30 fps per camera
Maximum Recording Throughput	16 Mbps

• Storage

Interface	Serial ATA
HDD Bay	Maximum 2 disks (disks not included)

• Search & Playback

Time Based Video Search	Search video recordings by time, channel or bookmark
Event Based Video Search	Search event triggered video recordings
Playback Control	Forward and backward playback with speeds 1/2x-1x-32x; pause; stop
Synchronized Playback	4 channels
Manual Snapshot	Create snapshot from playback for export
Video Cropping	Crop a short video clip from long recording file and save it as an independent file; video clip length:(1-30mins)
Video Export	Export video clips in AVI/RAW format via USB storage

• Event Management

Event Trigger	Video motion detection; External device through digital input; Video loss and recovery; Network loss and recovery
Event Response	Record video; Play alert beep; Activate external device through digital output; E-mail notification with snapshots; Event logging; Go to PTZ preset point; Pop-up instant playback

• System

FW Upgrade	FW Upgrade via USB mass storage
Configuration backup/restore	Configuration backup/restore via USB mass storage
Permission Control	Multi-group/users, liveview/playback/setup/remote level permission
Data Backup	USB mass storage
Operating System	Embedded Linux
System Status Monitor	Real time status reports on remote browser
Language	English

• Remote Access

PC Web Browser	Microsoft Internet Explorer 9.0
----------------	---------------------------------

• Hardware

Dimensions (W x H x D)	135 mm x 121 mm x 241 mm (5.3" x 4.8" x 9.5")
Weight	1.33kg (2.93 lb) without HDD
Operating Temperature	0°C~ 40°C(32°F ~ 104°F)
Operating Humidity	10% ~ 85% RH
Power Source / Consumption	DC 12V/ 50W
Bundled Accessories	Power Adapter, (100~240V) with 3 different connectors included
Approvals	CE (EN 55022 Class B, EN 55024), FCC (Part15 Subpart B Class B) Adapter: CE, FCC, UL, PSE, EFFICIENCY LEVEL V
USB	USB 2.0, 2 ports
Ethernet Port	2, Ethernet (1000 Base-T), RJ-45 connector, Built-in DHCP server support on Ethernet Port 1
Display port	HDMI

• Integration

Unified Solution	Fully compatible with ACTi camera with H.264 compression
------------------	--

* All specifications are subject to change without notice.

* All brand names and registered trademarks are the property of their respective owners.

www.acti.com

